

# SydLug Death Star Hallways Lighting Kit

Before we start, I thought I would go over a couple of things in case you have not used any of our lighting before or if you have you will note a few differences to our usual kits.

In making this kit I had to consider a couple of things and probably the most important of this was that it will need to be flexible. I do not know what changes you might make to the initial plans to make your hallways your own so the wires are longer than I would have them for one of our standard kits. It will allow some flexibility for using the lights in other MOCs too.

It uses thicker wire than my usual kits except for the wire to the 1x2 trans red plate. The hallway designs allow plenty of room for wiring.

You will also note that each part has both a male and a female end. This will allow you to power more than one module simply by linking them together.

Your kit should have the following parts besides a battery pack per module and a USB plug per order.

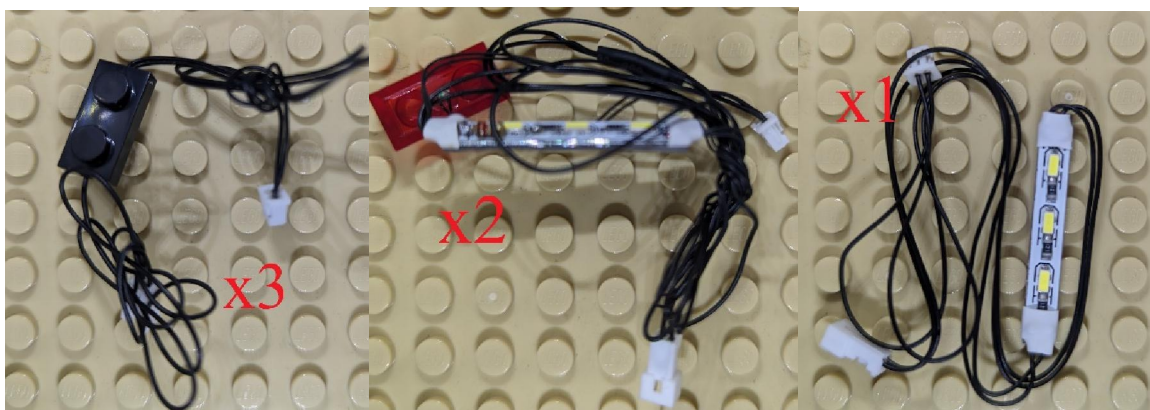

1x2 Downlight

1x2 Red + 1x4 Adhesive

1x4 Adhesive

Separate the modules and remove a bunch of stuff.

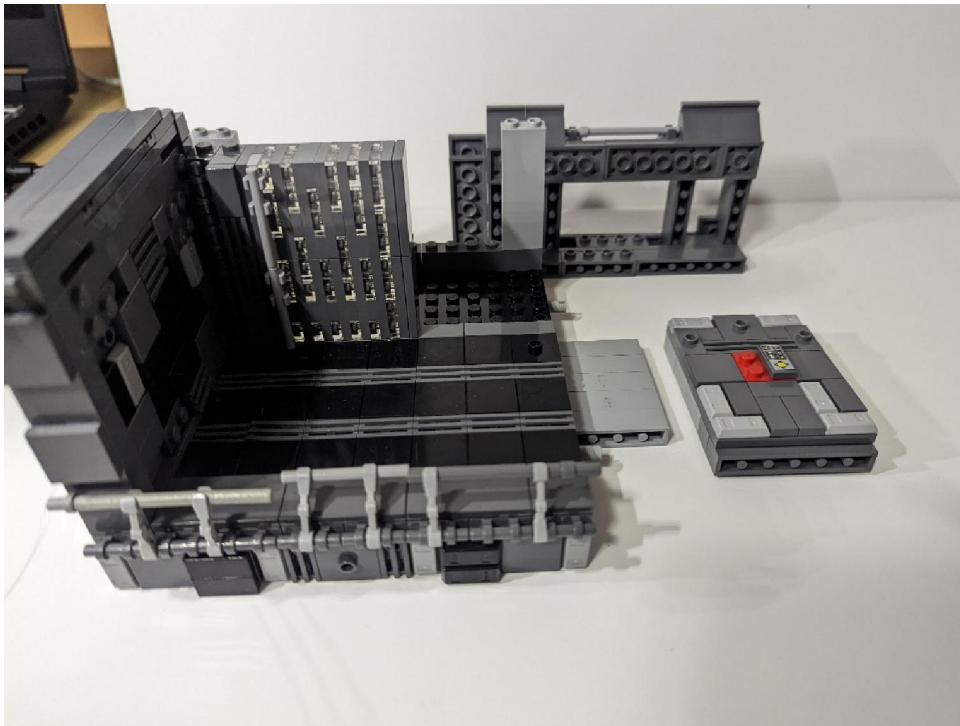

Add the 1x2 trans red + 1x4 Adhesive plates as shown below.

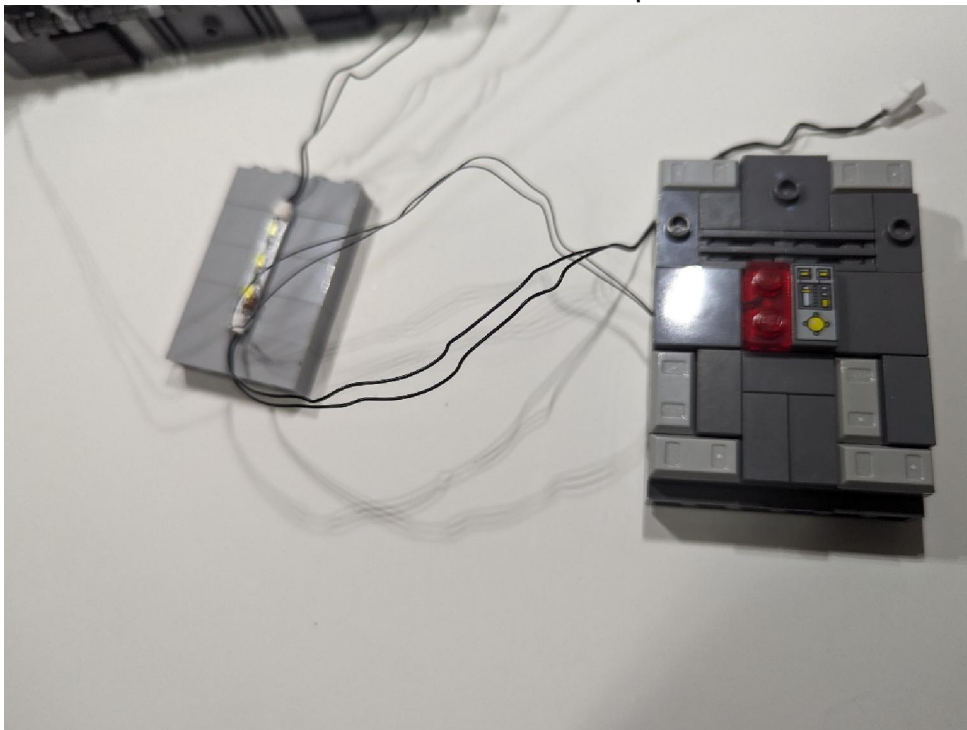

Repeat for the other side.

If you have done a center version with the clear 1x2 plates you can use the remaining 1x4 adhesive part there.

After restoring the modules to their original glory it should look like this

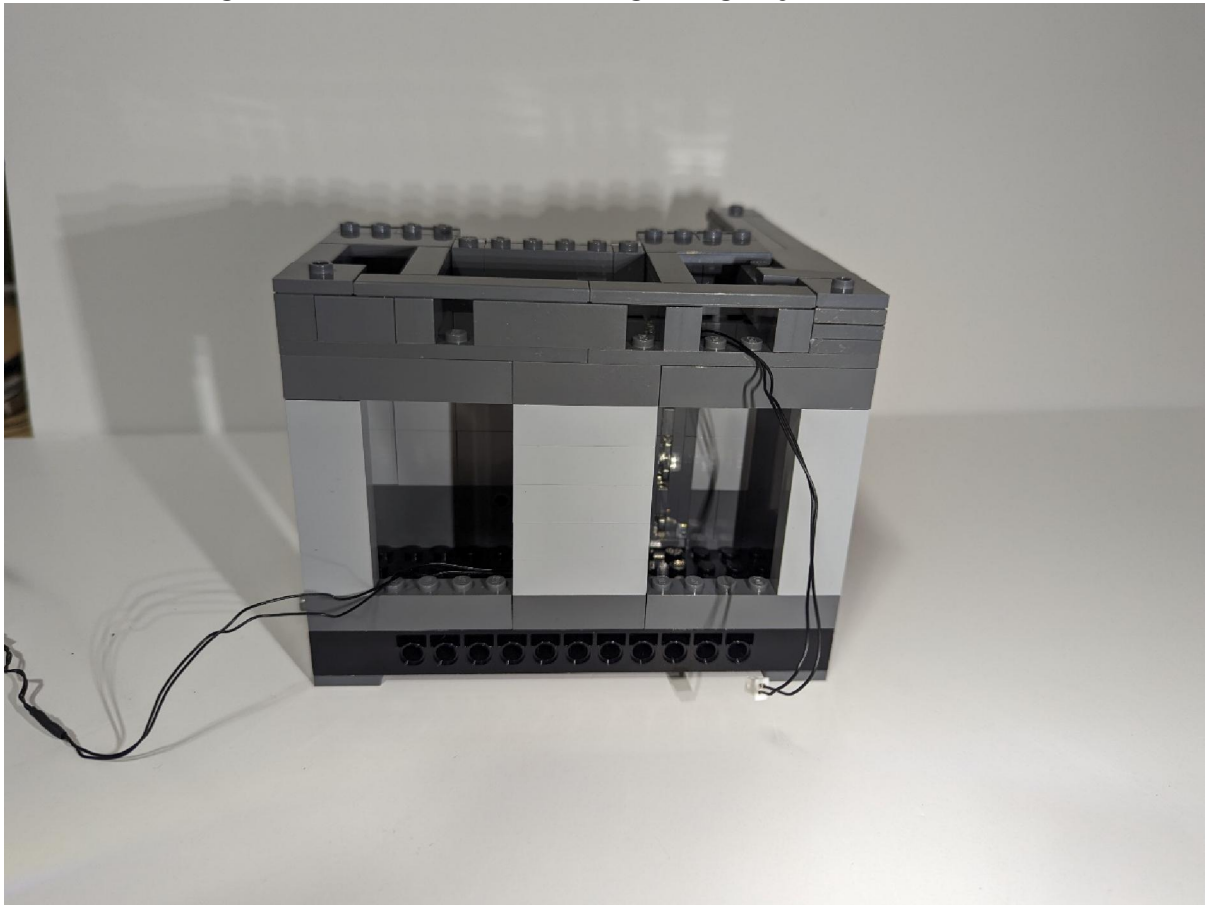

You can then join the modules together, join the wires and it will look like this.

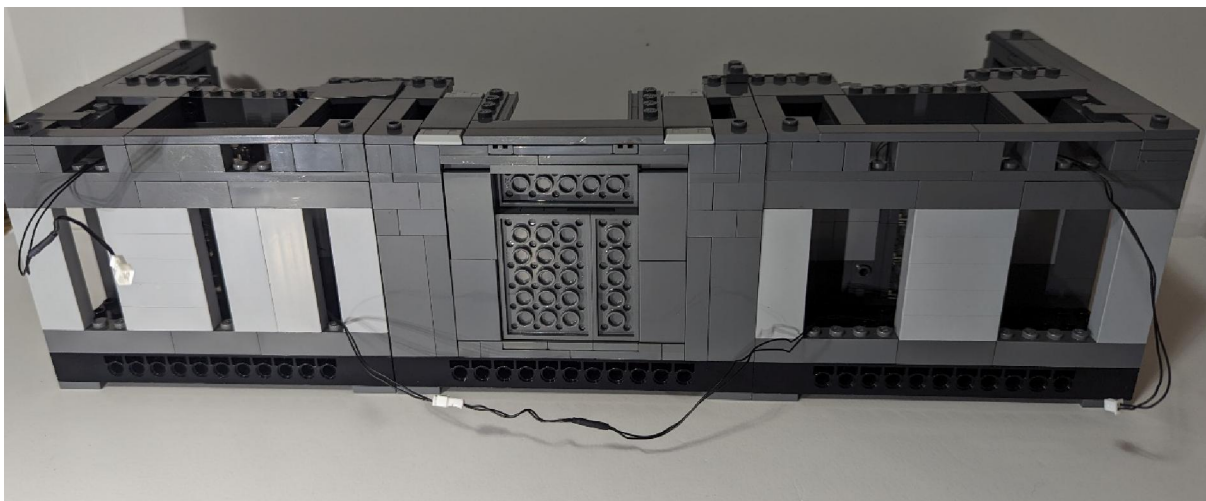

Now get the 3 1x2 Downlights and install them into the following positions. Ensure that you have the male and female ends opposite to the lights you have already installed. Use 1x2 plates to help tidy up the wires but always make sure that the wires are between the studs to prevent cutting the wires.

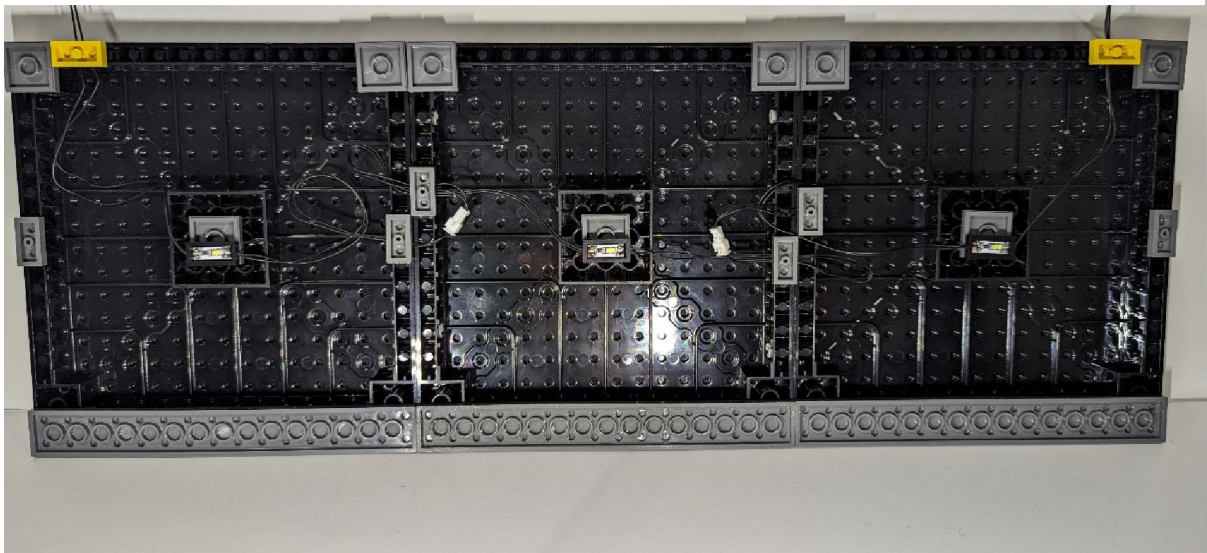

If you have put the male and female plugs different ends as was suggested, you will now be able to link up the two series of lights to use just a single power connection from either the battery pack or using the USB plug that was included.

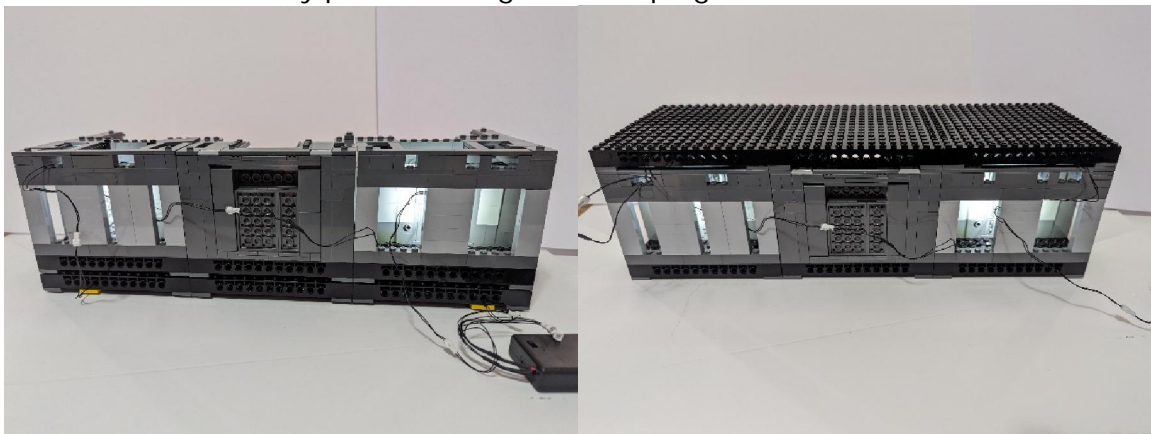

This means you can also join up multiple modules with just one connection used. If you are connecting yours to another person's display and they have the

connections at the wrong end you can easily disconnect and then reconnect like shown in the pics below.

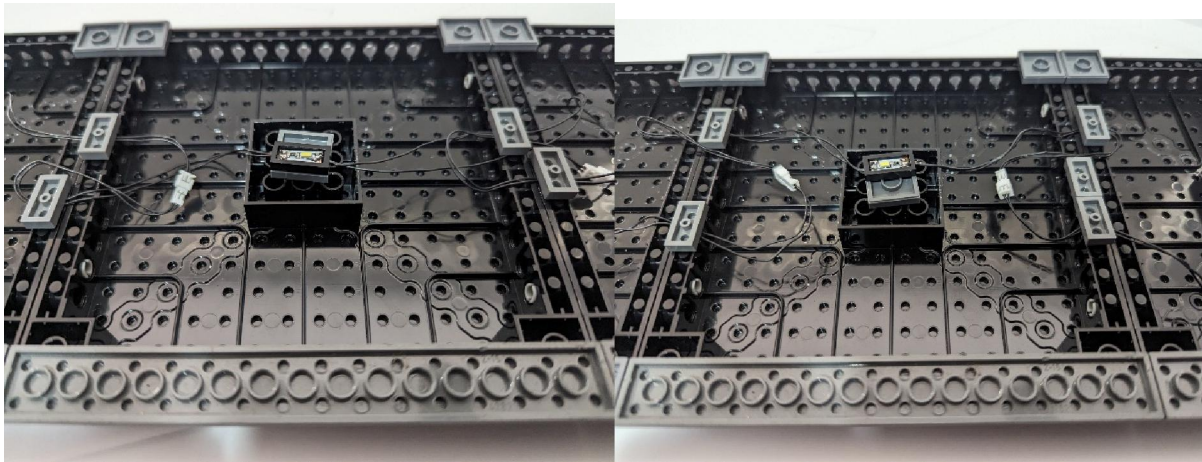

Or if its not being used you can bridge the connections using the third adhesive 1x4 plate

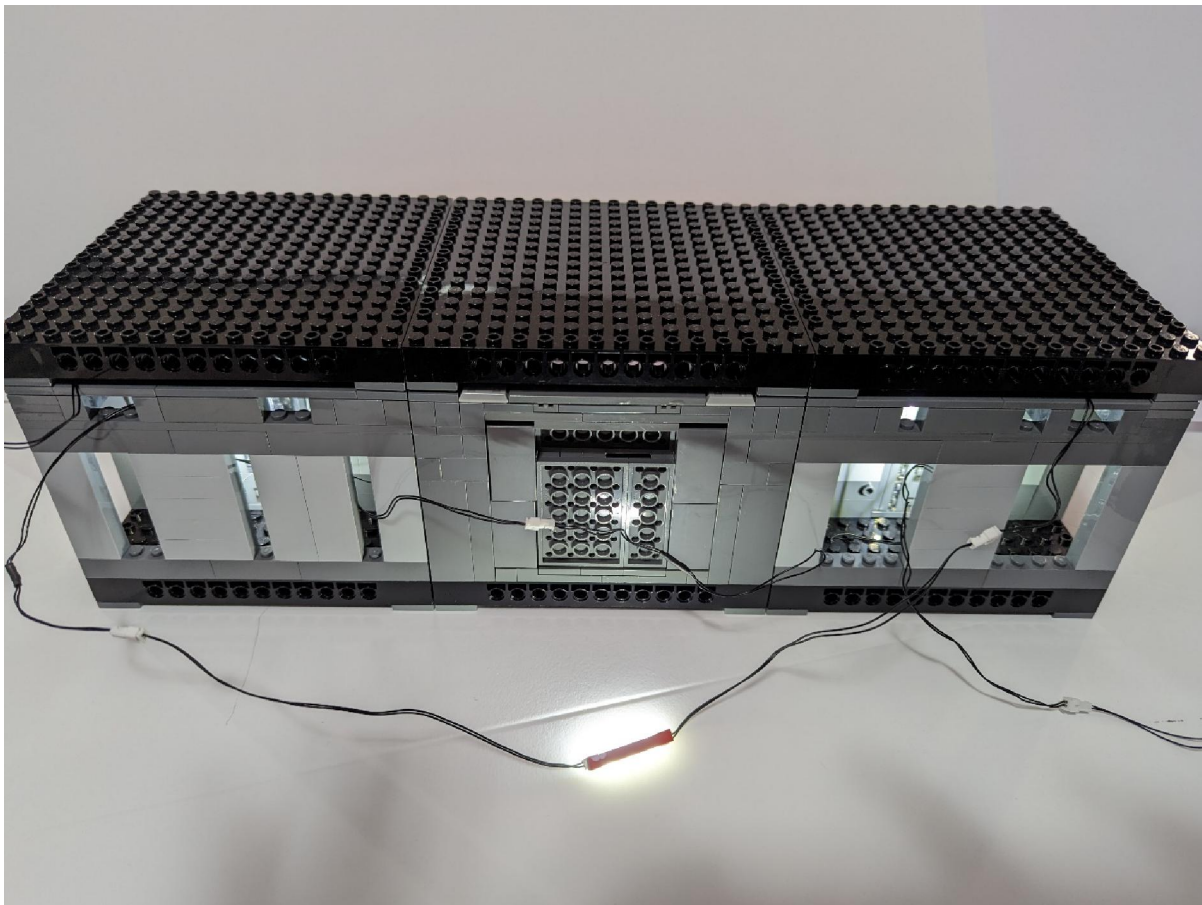

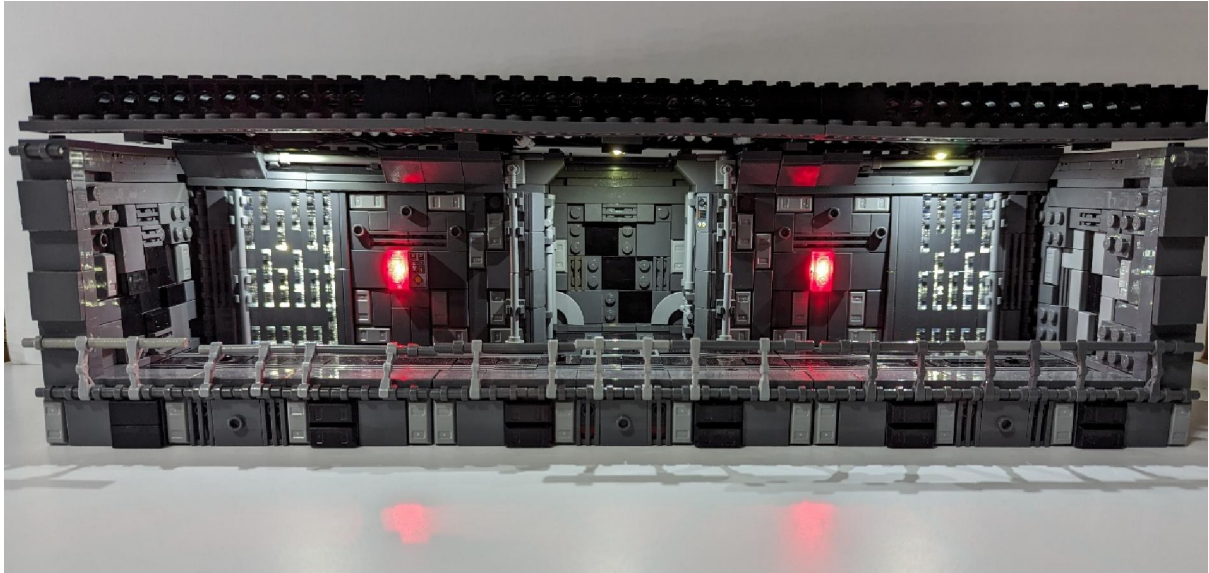

You will have extra mini plug connection points left over from the battery packs you have received and is compatible with all my DIY parts. You can add lightsabres for example.

