

Lego 21035

Solomon R. Guggenheim Museum

Installation Guide

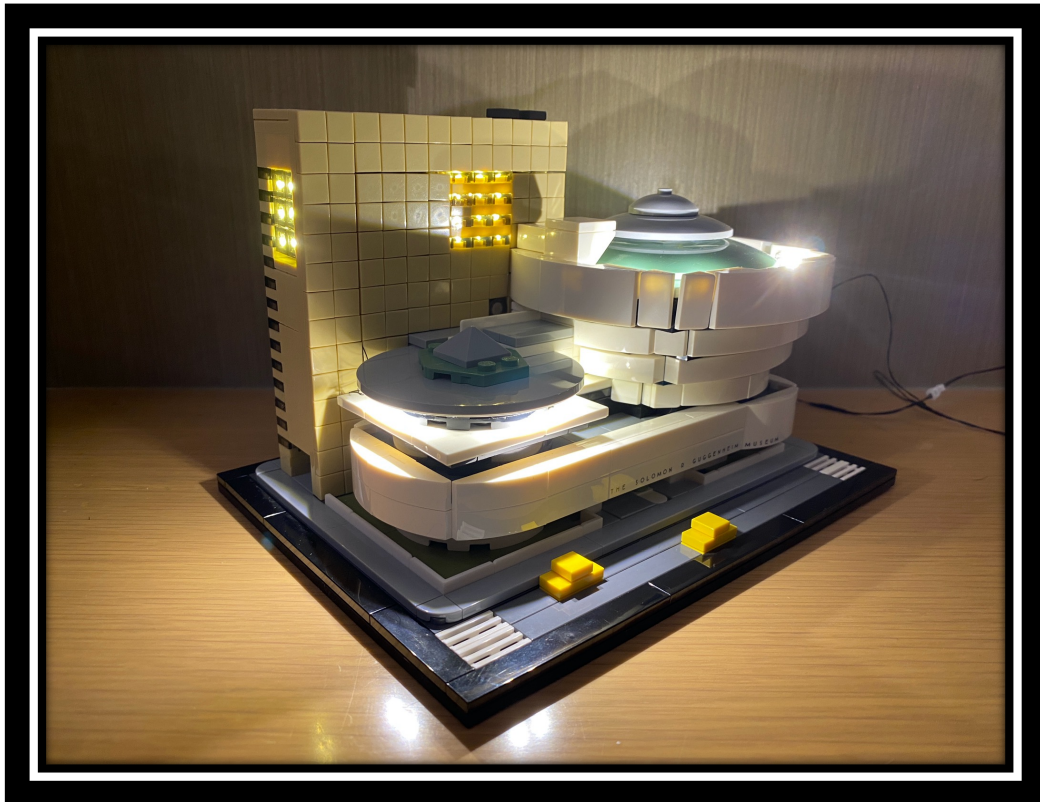

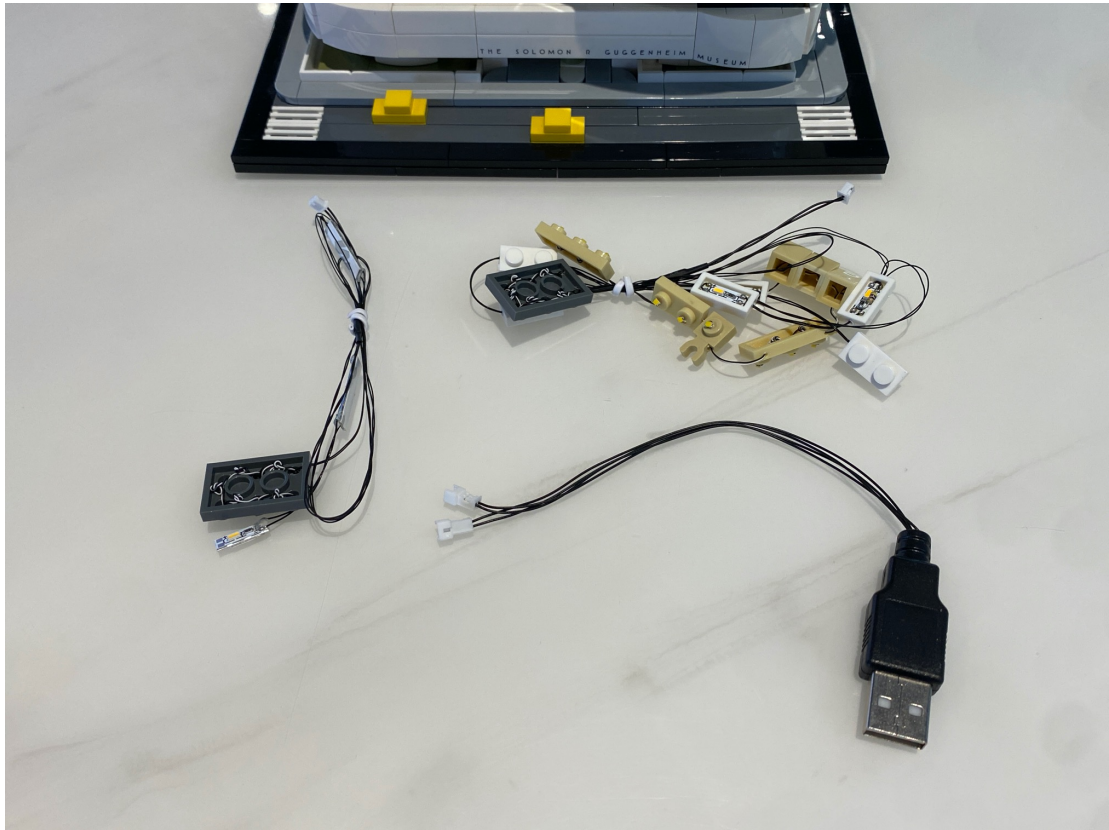

First, split the whole building as shown

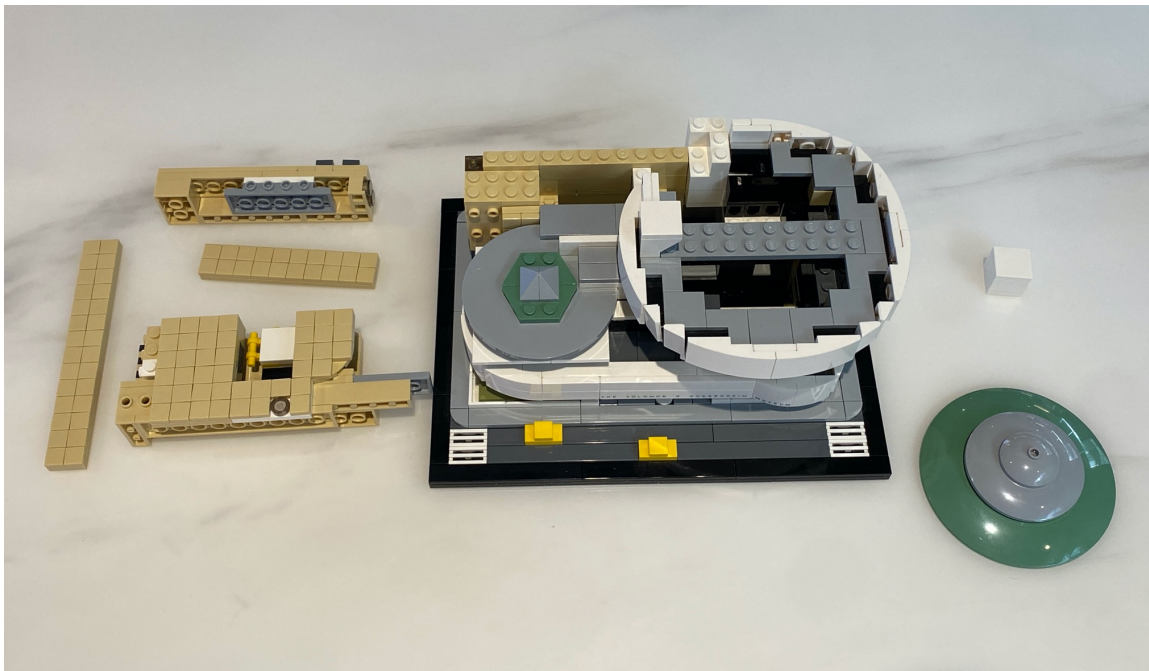

Remove the round plate and the tiles and take this lighting parts

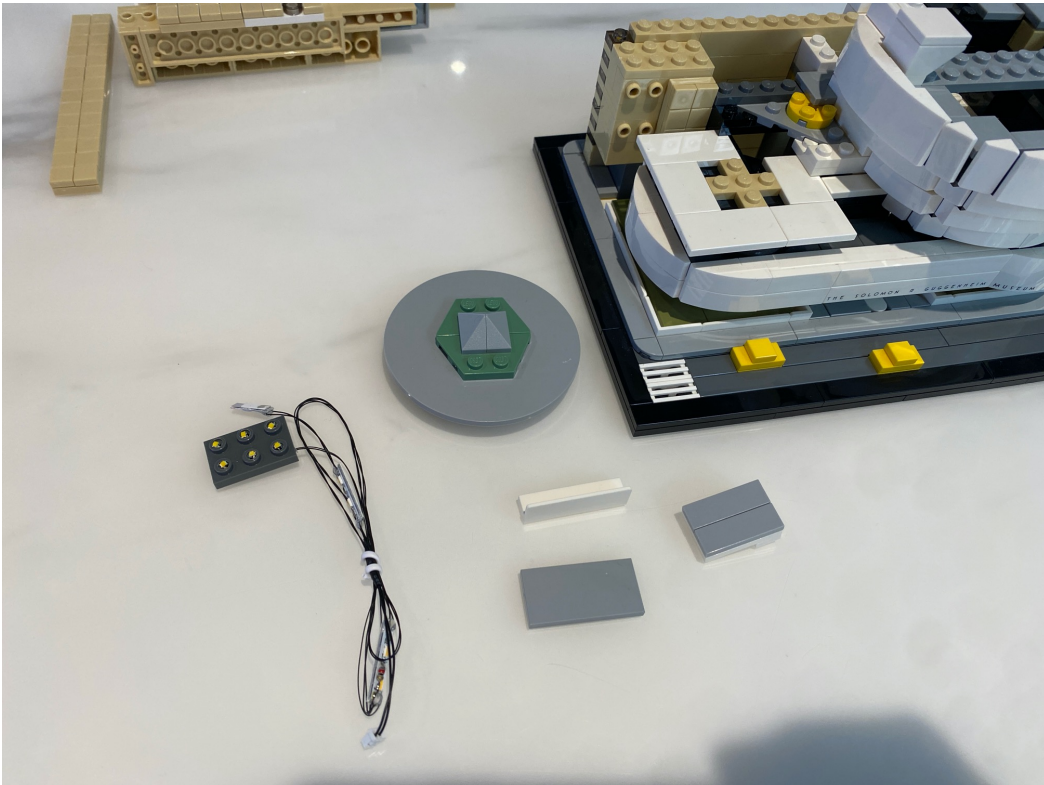

Stick the led bars under the grey round tile
Watch out the short bar has to be sticked right as the edge, otherwise it would be blocked by the parts below when restoring back

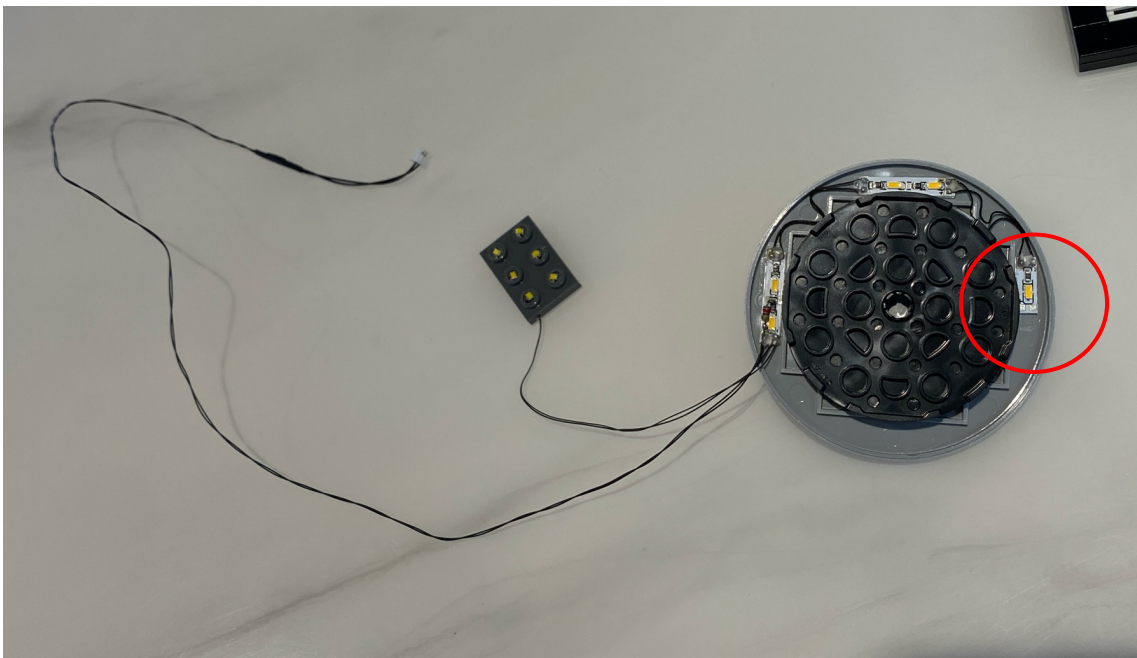

It should be look like this when restoring the round tile



Put the round tile and the other tiles back

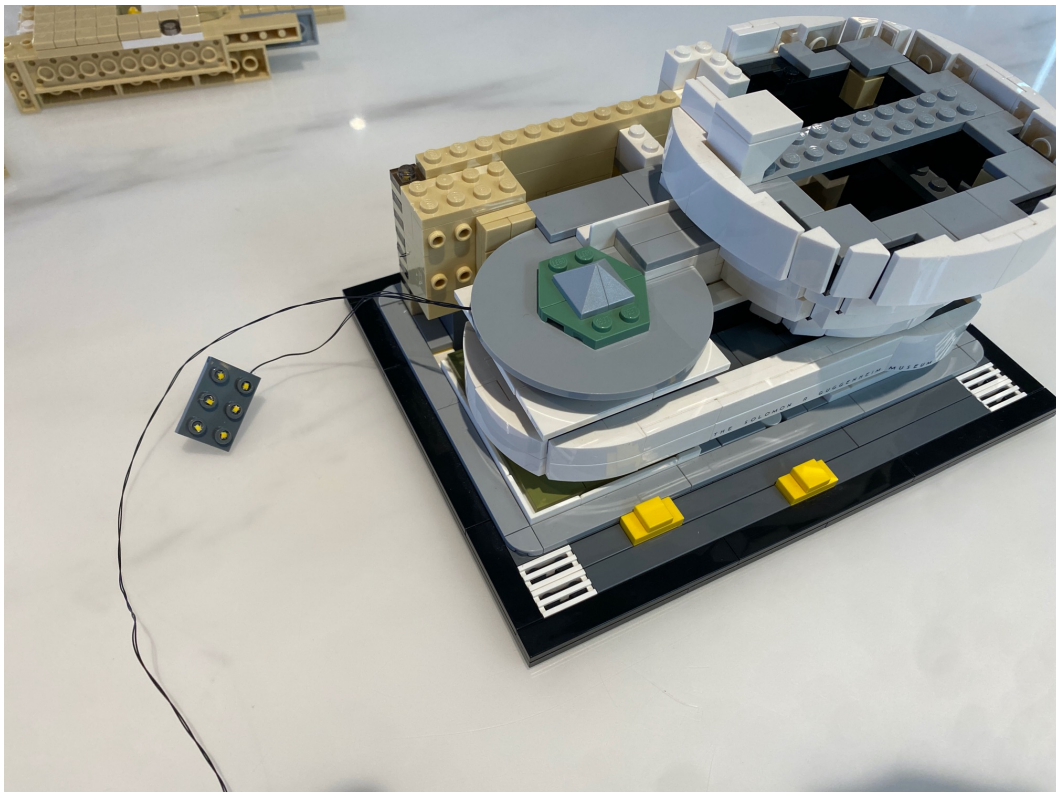

Settle the wire with connector at the back, restore the parts above and assemble the lighting plate, stable the wires in between the studs then restore the surface wall

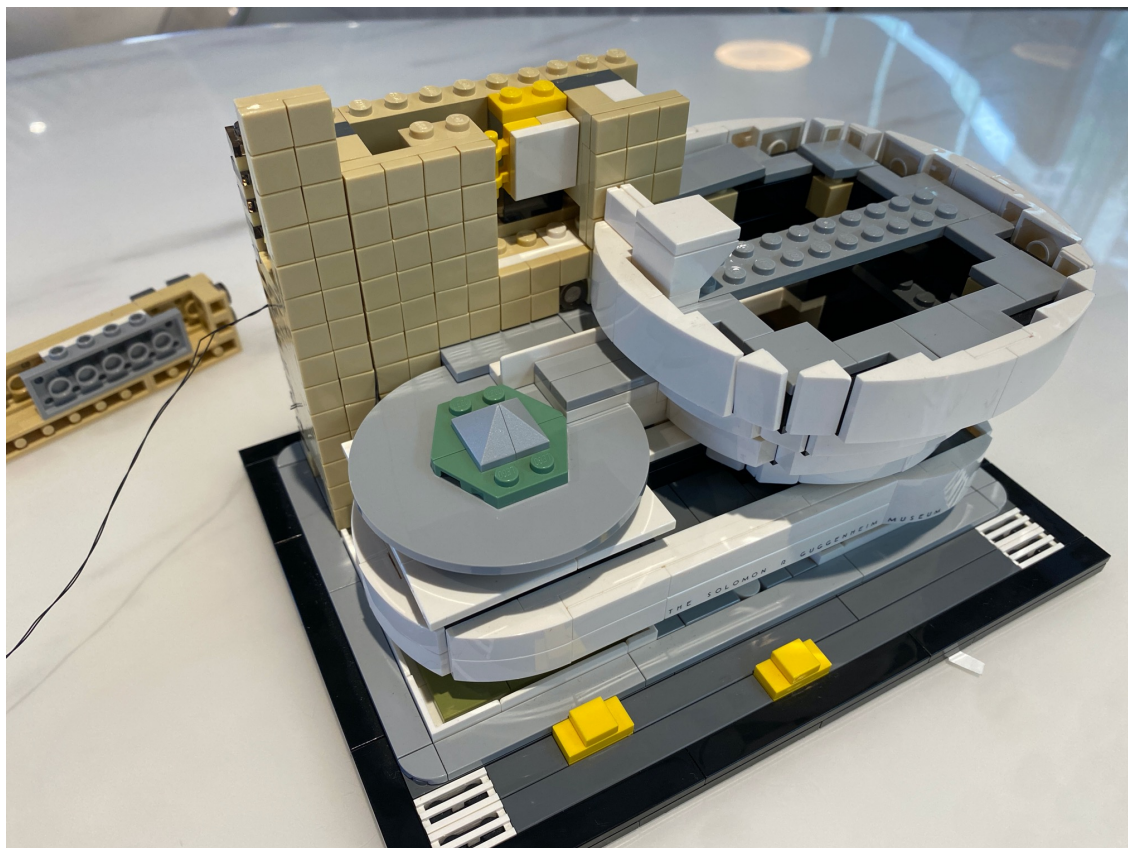
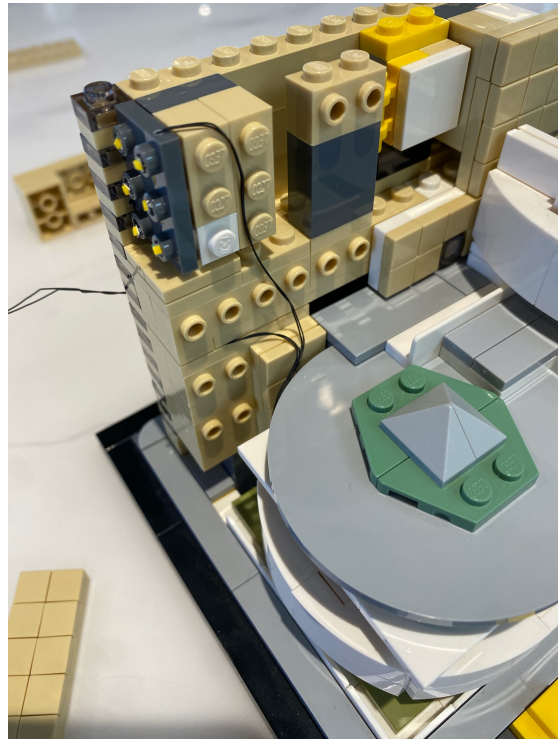
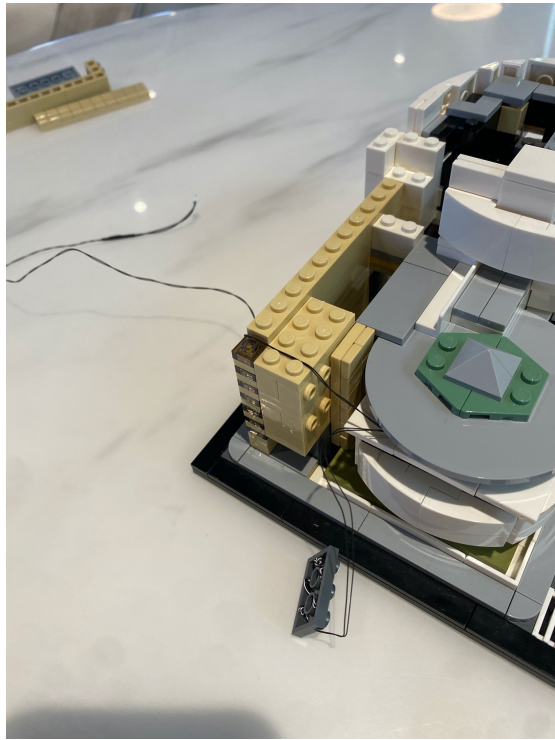

Then put the clear black tiles on the lights

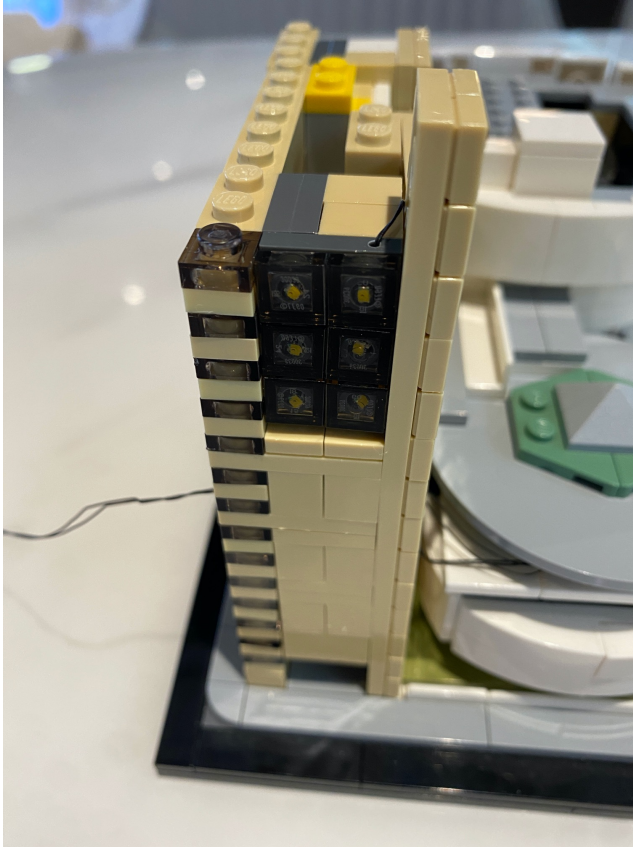

For the other lighting parts, replace them with the correspond parts

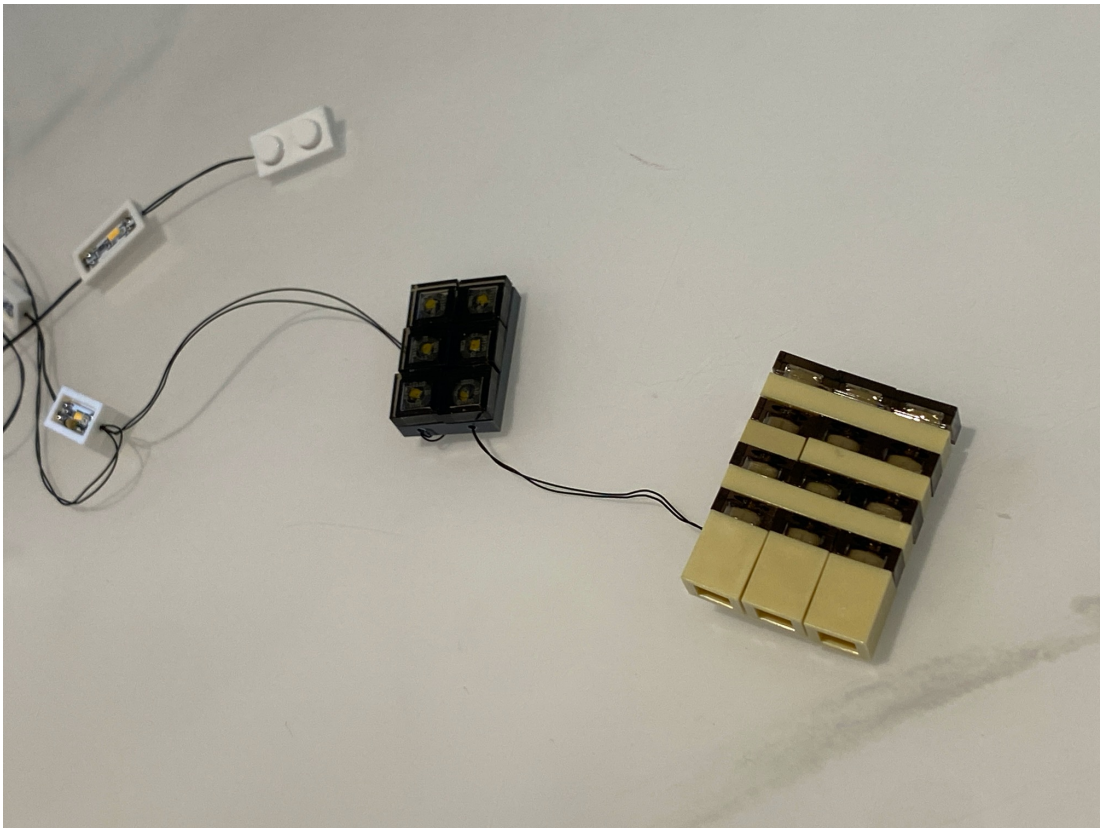

Assemble the parts from previous step to the building then restore the removed parts from step 1



For the remain 1x2 white lighting plates, assemble them on the top as shown

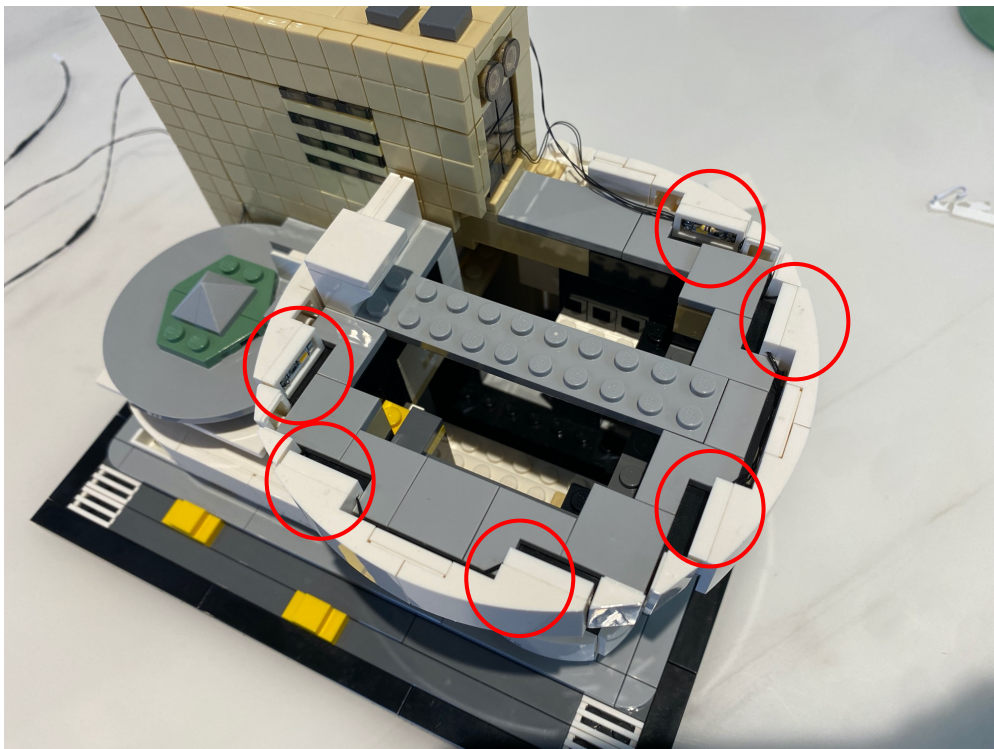
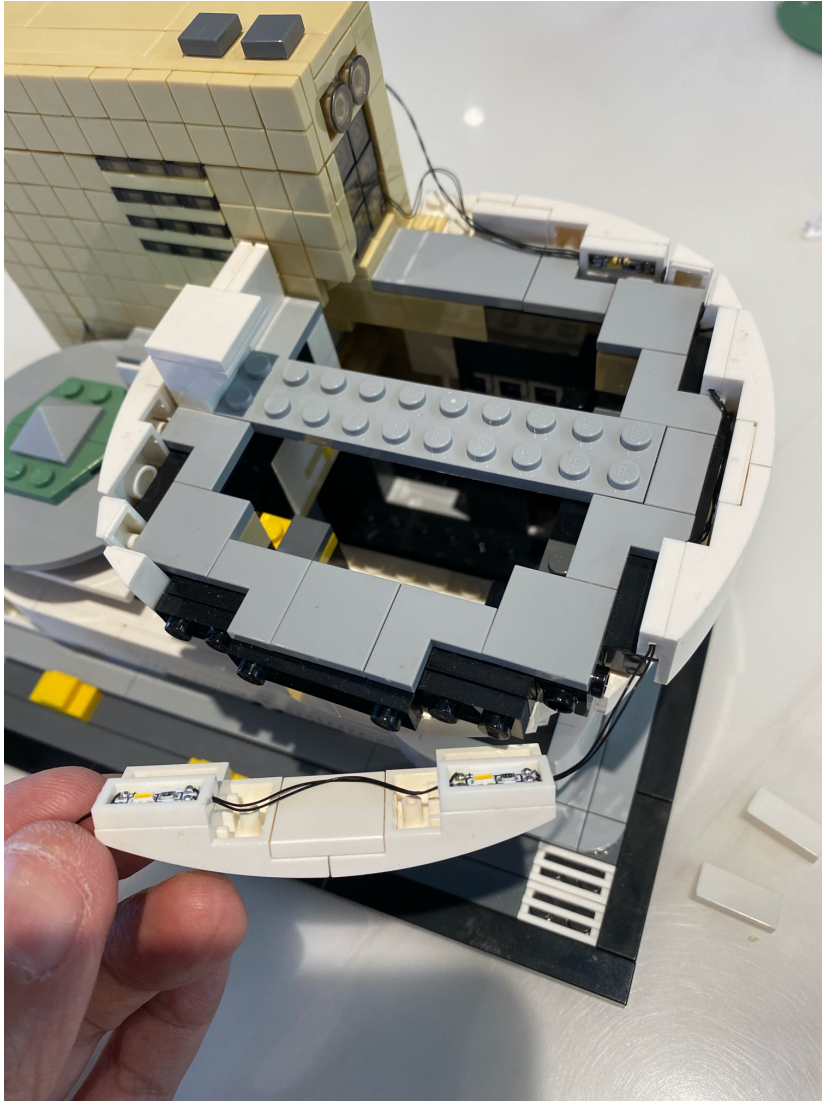

Hide the cable at the shown area in between the studs and cover by the brick

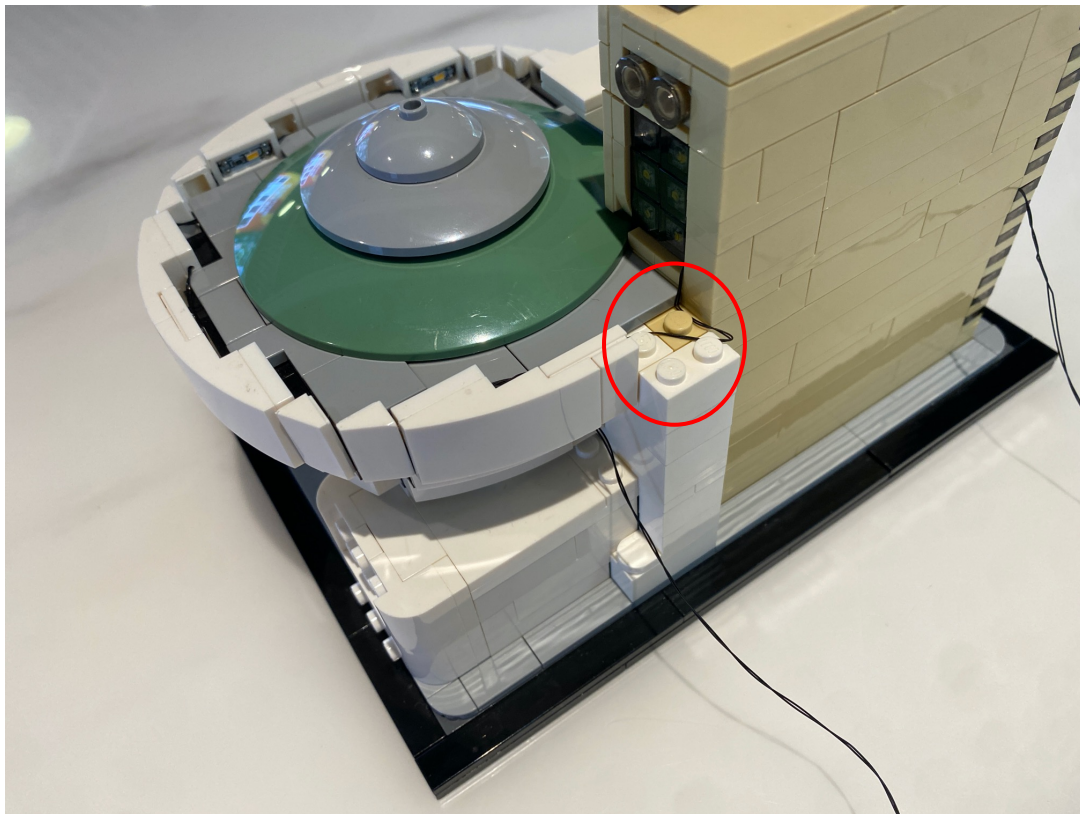

At last connect with the USB cable and it's done

